

BUILDING DESIGN & CONSTRUCTION SYSTEMS - MINI-MOCK EXAM

1. Which of the following is NOT true regarding bentonite waterproofing?

A. It is made with volcanic clays

B. It swells to a watertight barrier

C. It can be installed on top of a mudslab in a crawl space

D. It can be installed in a hydrostatic condition

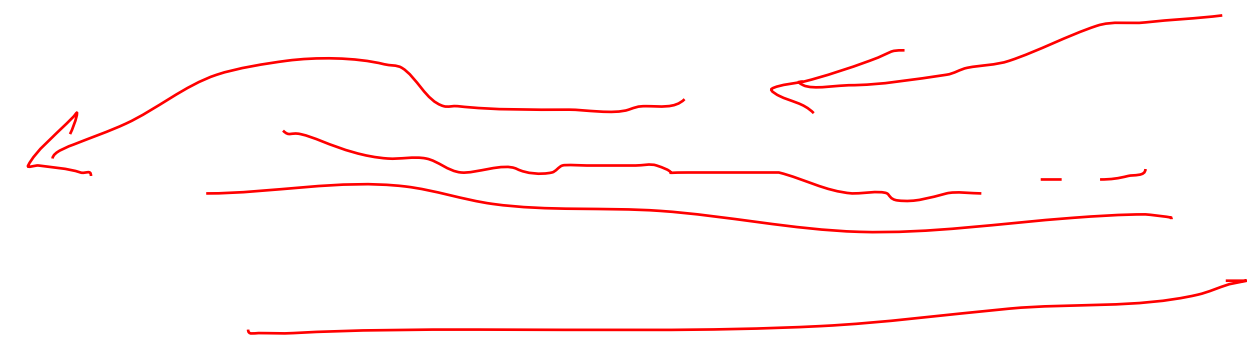

BUILDING DESIGN & CONSTRUCTION SYSTEMS - MINI-MOCK EXAM

2. What is the nominal dimension of a CMU block?

— X X —



BUILDING DESIGN & CONSTRUCTION SYSTEMS - MINI-MOCK EXAM

3. What is the nominal dimension of an 8' 2x6?

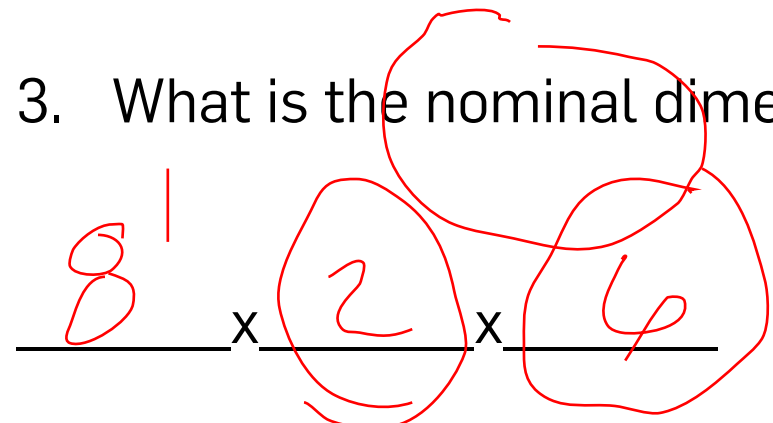

$1\frac{1}{2}'' \times 5\frac{1}{2}'' \times 8'$

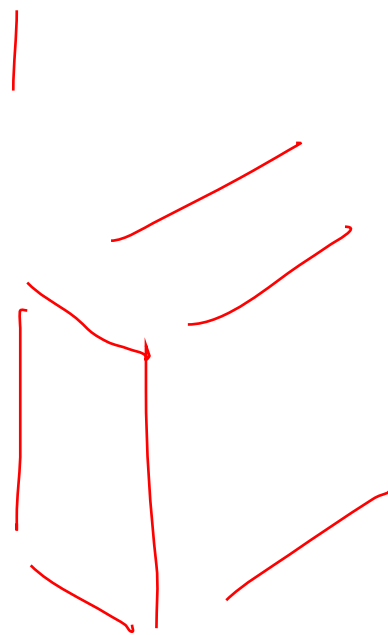

$2 \times 4 \quad 1\frac{1}{2} \times 3\frac{1}{2}$
 $2 \times 6 \quad 1\frac{1}{2} \times 5\frac{1}{2}$
 $2 \times 8 \quad 1\frac{1}{2} \times 7\frac{1}{4}$
 $10 \quad 9\frac{1}{4}$
 $12 \quad 11\frac{1}{4}$

BUILDING DESIGN & CONSTRUCTION SYSTEMS - MINI-MOCK EXAM

4. You are estimating how many bricks you will need to order for a 48" wide, double wythe wall that is 32" tall wall for a part of a patio design. The bricks are normal, standard bricks. How many do you need?

- A. 72
- B. 144**
- C. a square of bricks
- D. 768

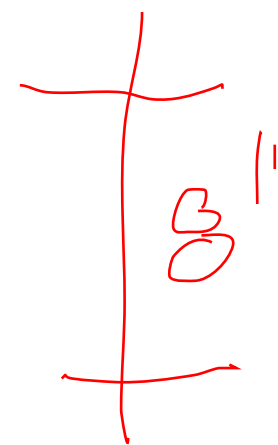
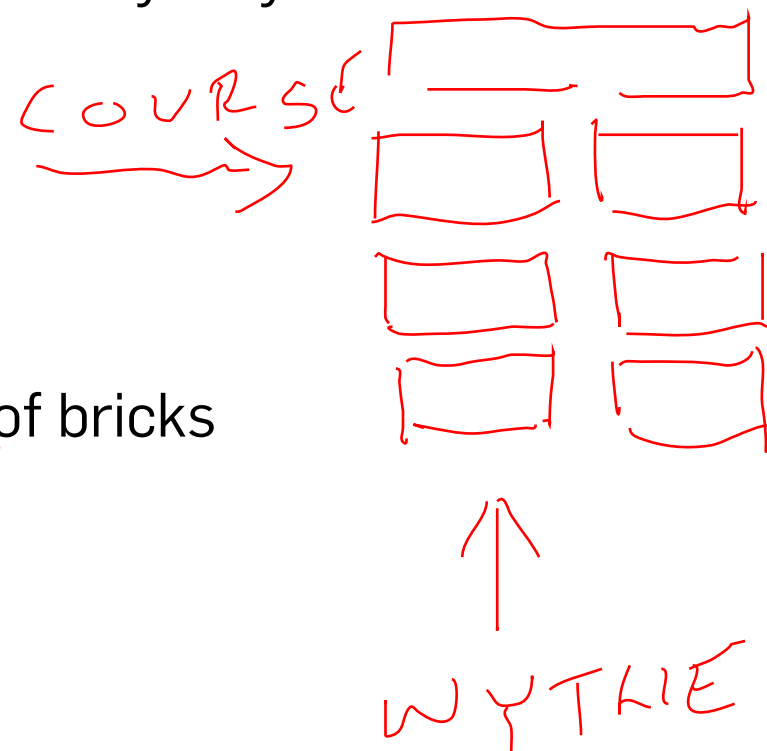

$12 \times 4 = 72$

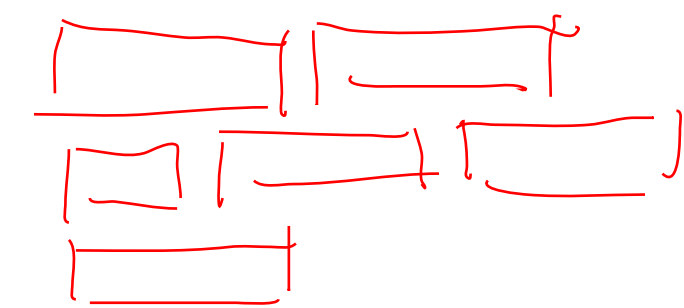
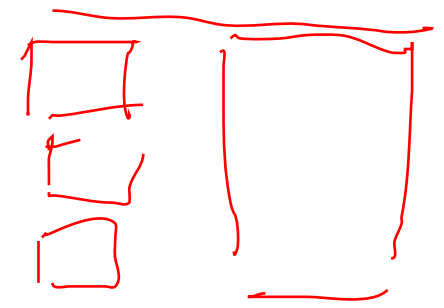
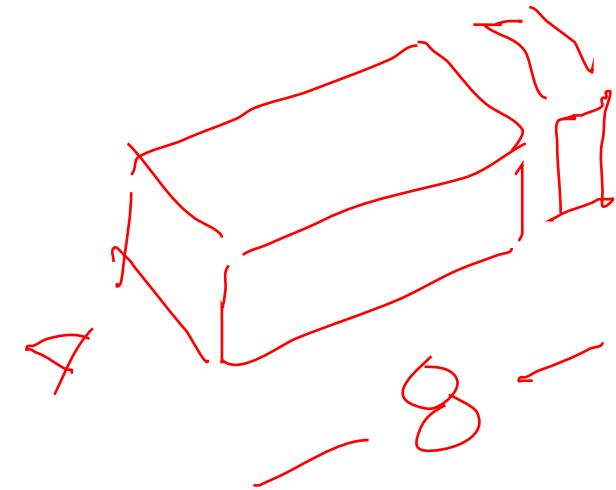

BUILDING DESIGN & CONSTRUCTION SYSTEMS - MINI-MOCK EXAM

5. How many risers are there in the sketch of the library stair:

- A. 24R
- B. 23R
- C. 22R
- D. 25R

$8' - 10'' \rightarrow 96 + 10 = 106''$
 $106 \div 7 = 15.14 \rightarrow 16R$
 $106 \div 16 = 6 \frac{5}{8}''$
 $13' - 6'' \rightarrow 156 + 6 = 162''$
 $162 - 106 = 56''$
 $56 \div 7 = 8$
 $8R @ 7''$

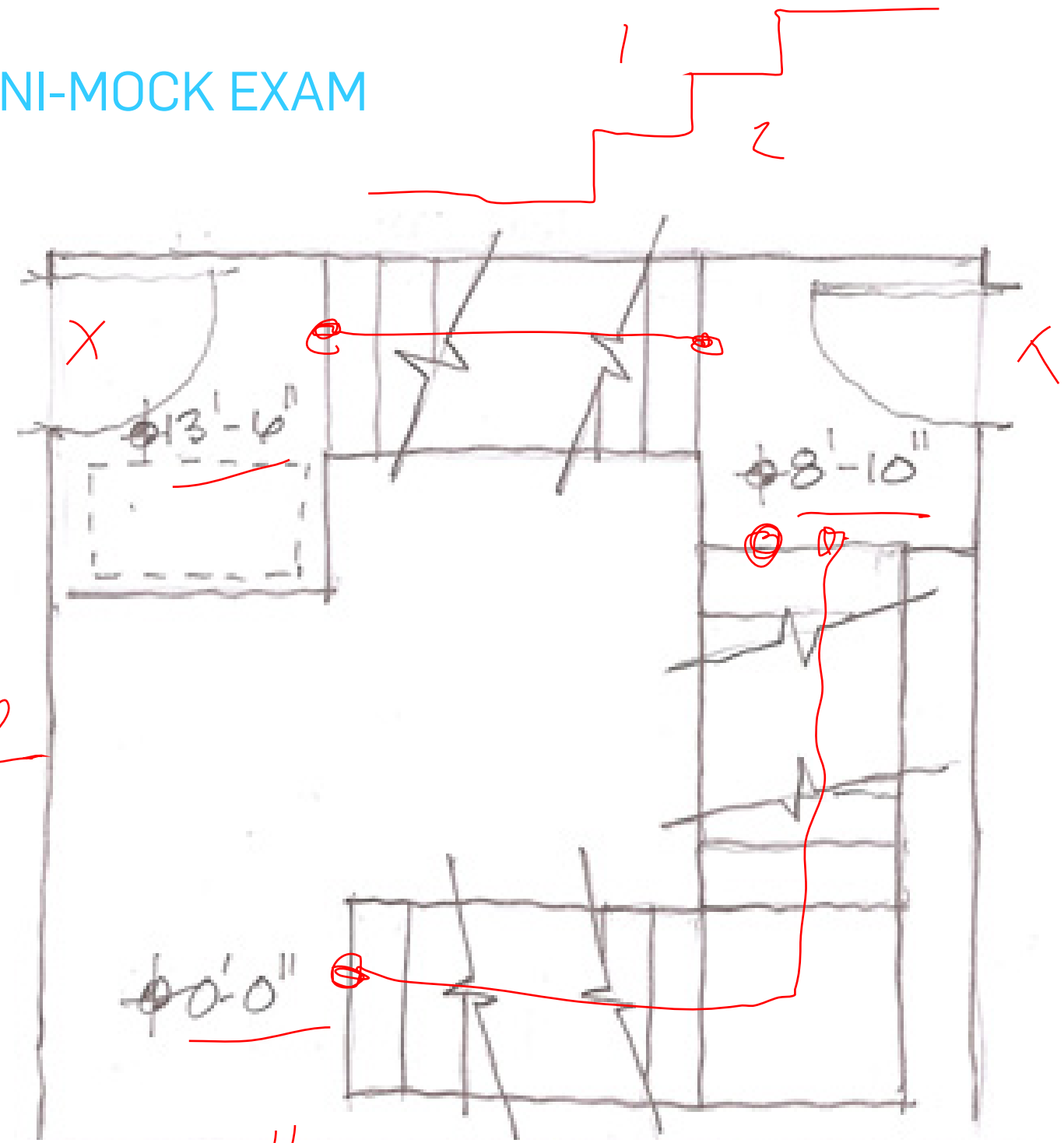

BUILDING DESIGN & CONSTRUCTION SYSTEMS - MINI-MOCK EXAM

6. What is the steel thickness range for light gauge cold rolled metal framing?

A. 30 gauge to 8 gauge

B. 20 gauge to 25 gauge.

C. 8 gauge to 1/8 inch

D. 12 gauge to 1/8 inch

$\frac{1}{30}$ " $\frac{1}{8}$ "

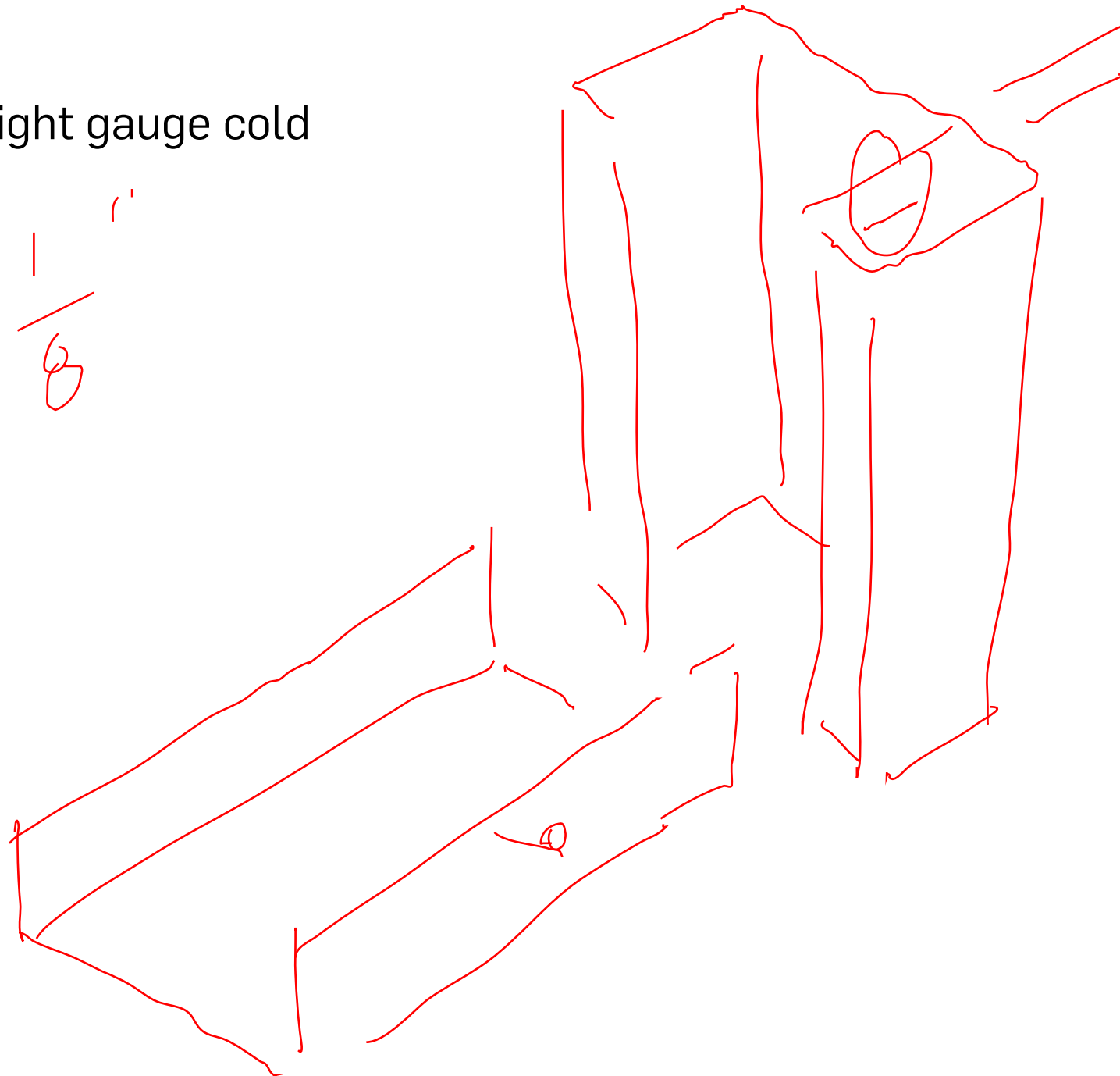

BUILDING DESIGN & CONSTRUCTION SYSTEMS - MINI-MOCK EXAM

7. Pozzolans are added to concrete mix for

_____.

STRENGTH

#

Superplasticizers are added to concrete mix for

_____.

WORKABILITY

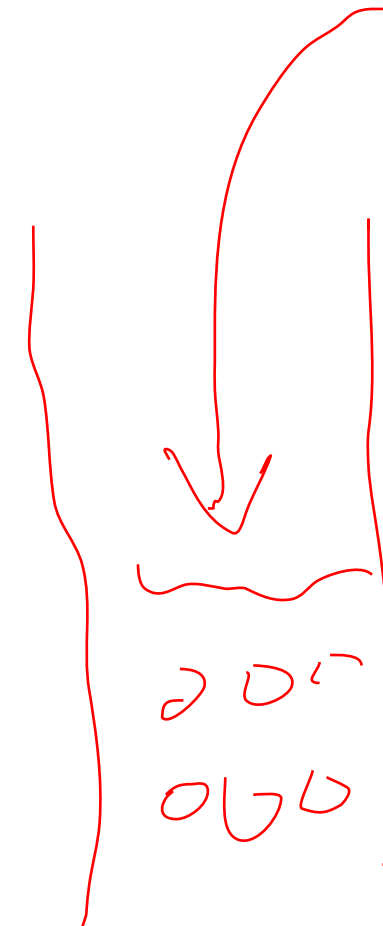

BUILDING DESIGN & CONSTRUCTION SYSTEMS - MINI-MOCK EXAM

8. How many board feet is there in a 2 x 6 joist measuring 12 feet long?

A. 18 board feet

B. 12 board feet

C. 24 board feet

D. 20 board feet

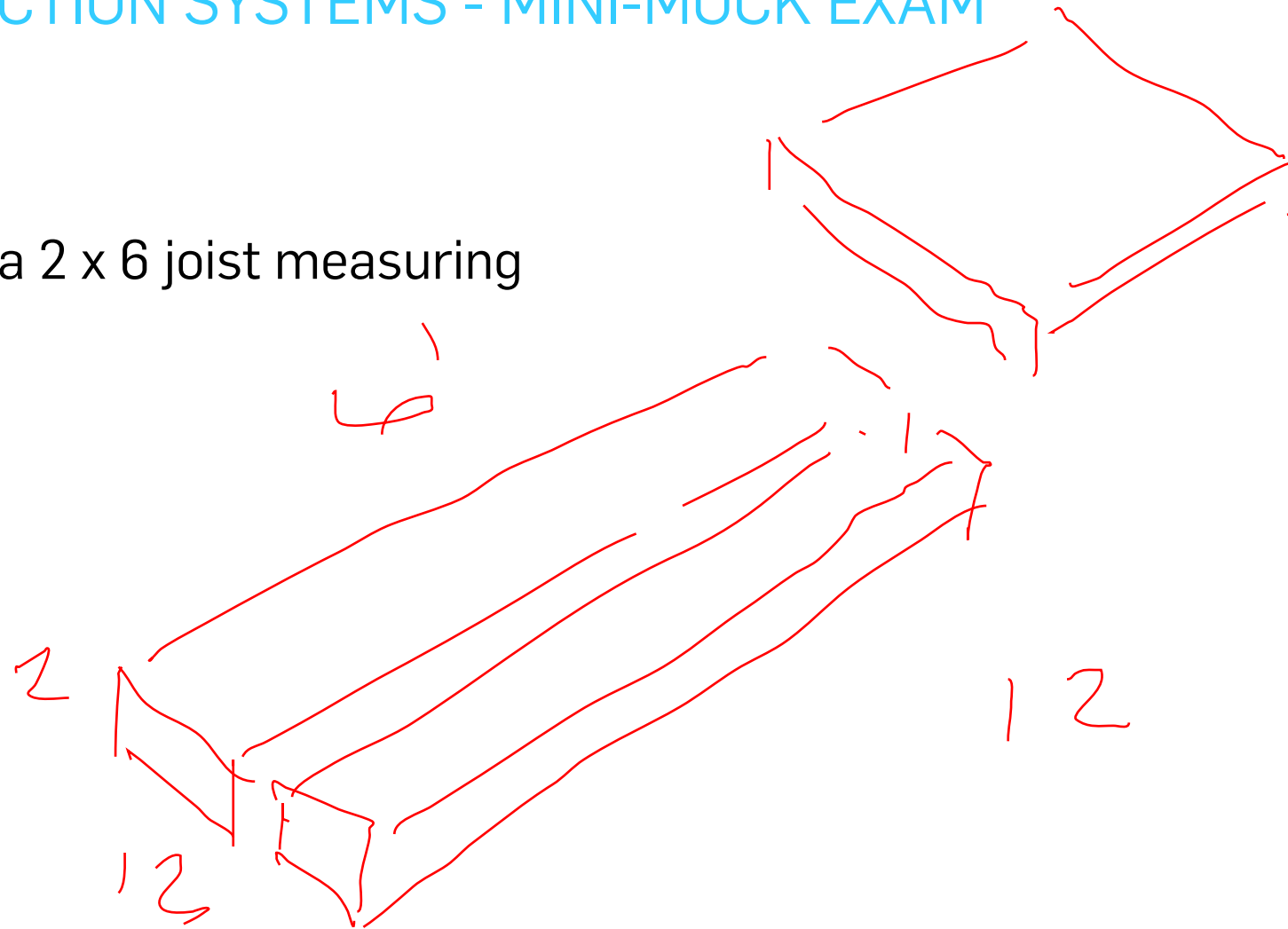

BUILDING DESIGN & CONSTRUCTION SYSTEMS - MINI-MOCK EXAM

9. Which of the following cuts from the same log would produce flooring with the best wearing characteristics?

- A. Quarter sawn
- B. Plain sawn
- C. Rotary sawn
- D. Half round sawn

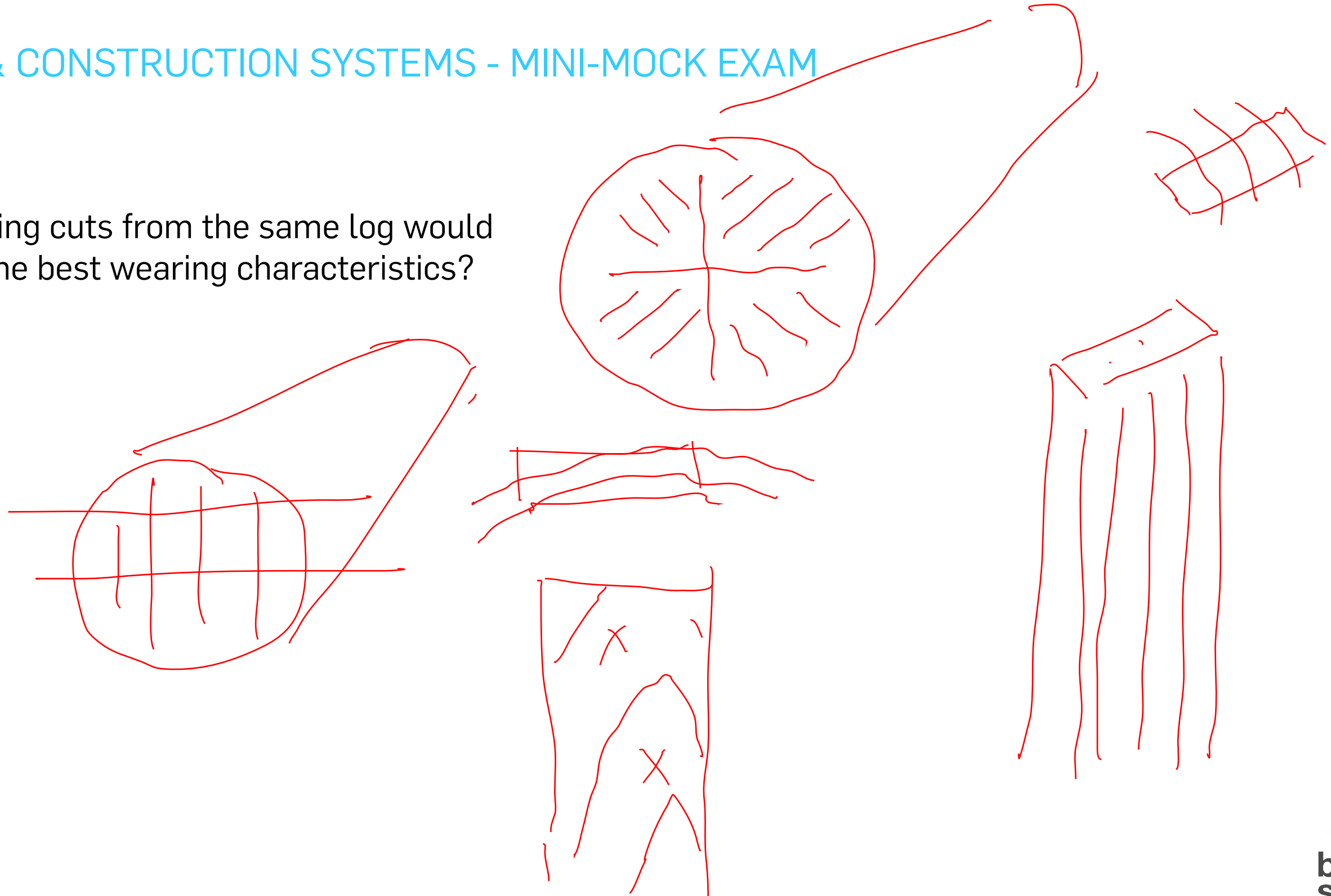

BUILDING DESIGN & CONSTRUCTION SYSTEMS - MINI-MOCK EXAM

10. Increasing the carbon content in steel has what effect?

A. Makes steel more flexible.

B. Makes steel less ductile.

C. Makes steel more corrosion resistant.

D. Makes steel easier to weld.

C. 1. 2% - 5%
3% 5%

BUILDING DESIGN & CONSTRUCTION SYSTEMS - MINI-MOCK EXAM

11. Which of the following is MOST characteristic of an end-bearing foundation element?

A. Timber piling

B. Belled Caisson

C. Steel micropile

D. Tapered precast concrete pile



BUILDING DESIGN & CONSTRUCTION SYSTEMS - MINI-MOCK EXAM

12. Standing at the jobsite watching the concrete coming out of the truck, I am worried about the concrete being too runny or wet, which test should I consider?

X A. Vane Shear Test

B. Cylindar Test

C. Slump Test

X D. ACT Test

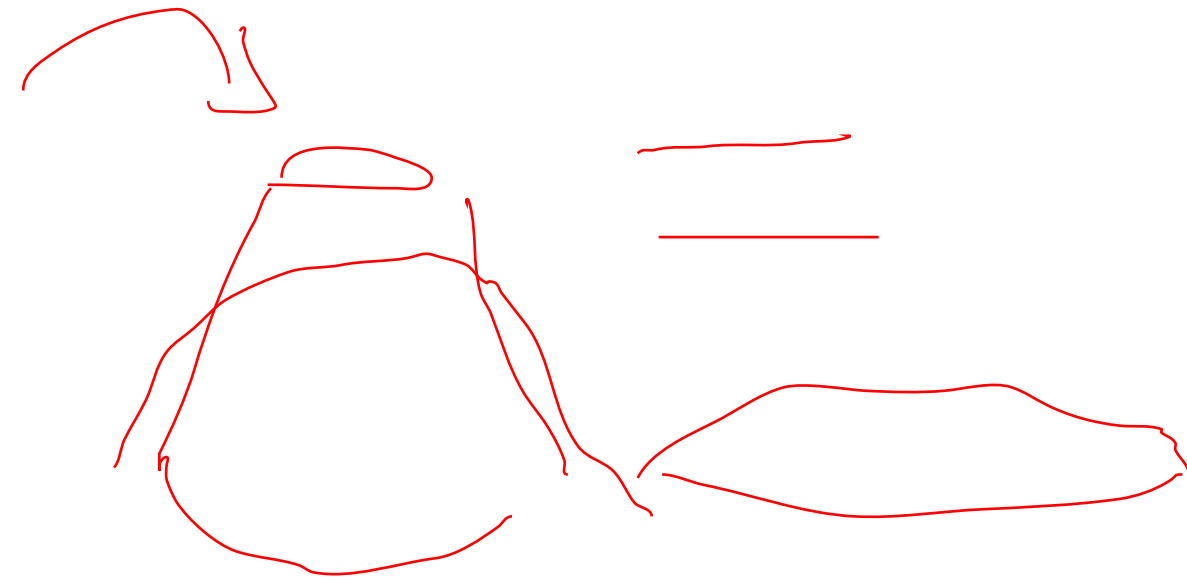
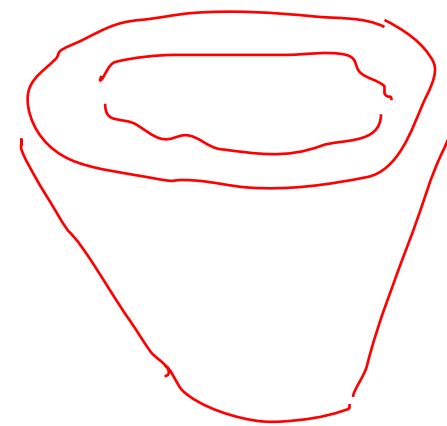
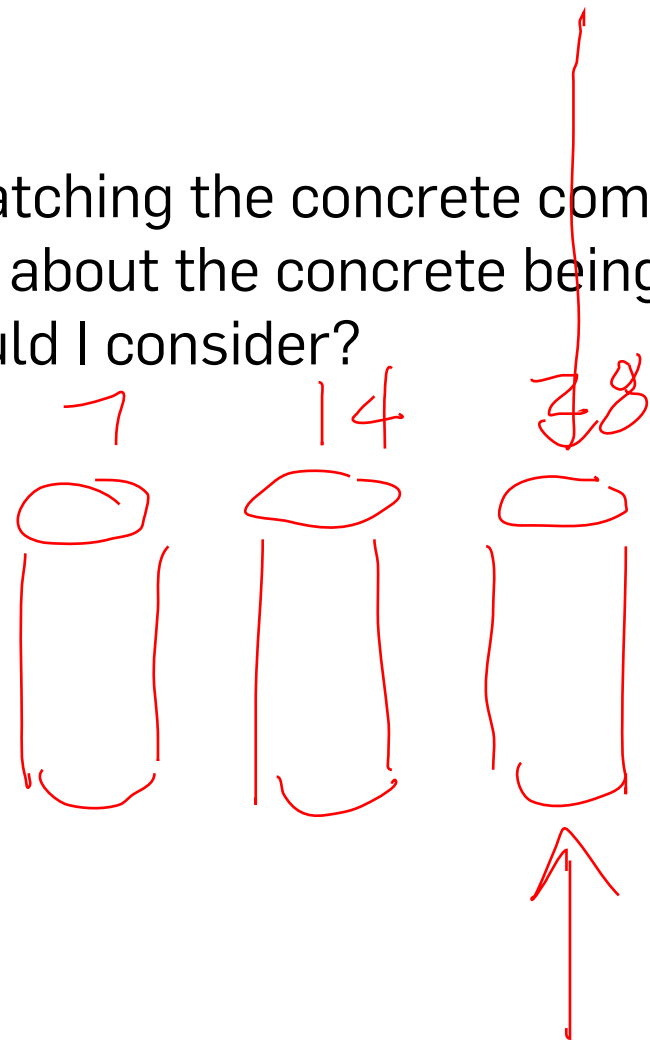

BUILDING DESIGN & CONSTRUCTION SYSTEMS - MINI-MOCK EXAM

Questions?